



# DYNADRILL EQUIPMENT PVT. LTD.

Plot # 2-199, Sai Baba Temple Road, Balanagar, Hyderabad - 500 042. Telangana, India  
 Ph: +91 40 23771243, Cell: +91 94400 48236 / 94406 09036  
 Email: dynadrill19&5@gmail.com , info@dynadrillequipment.com Website: www.dynadrillequipment.com



PERRY JOHNSON  
 REGISTRARS, INC.  
 ISO 9001:2008 Registered  
 Certificate No. C2914-0264

## FURY 60

### Shank QL 60 \ 65

Down-the-hole hammer

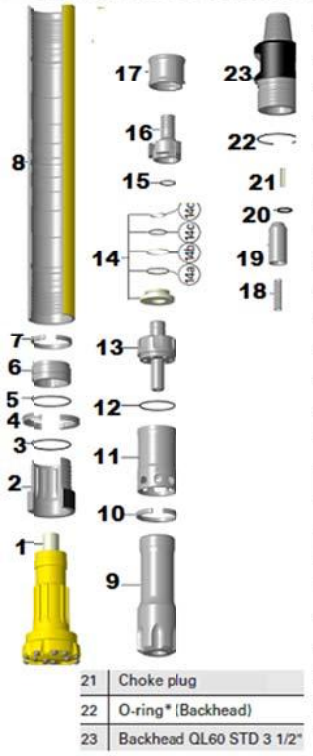

- 1 Exhaust tube
- 2 Chuck QL 60
- 2 Chuck QL 65
- 3 O-ring\* (Bit retaining ring)
- 4 Bit retaining rings
- 5 O-ring\* (Bit bearing)
- 6 Bit bearing
- 7 Lock Ring (Bit bearing)
- 8 Casing QL 60
- 8 Casing QL 65
- 9 Piston
- 9 Piston QL 60 HF
- 10 Lock ring (Cylinder)
- 11 Cylinder
- 11 Cylinder QL 60 HF
- 12 O-ring\* (Air distributor)
- 13 Air distributor
- 14 Valve assembly .050 Lift
- 14 Valve assembly .065 Lift (n
- 14a O-ring (Valve)
- 14b Seal-ring (Valve)
- 14c O-ring (Valve)
- 14d Seal-ring (Valve)
- 15 O-ring\* (Valve cap)
- 16 Valve cap
- 17 Solid spacer
- 18 Spring (Check valve)
- 19 Check valve assembly
- 20 O-ring\* (Check valve)
- 21 Choke plug
- 22 O-ring\* (Backhead)
- 23 Backhead QL60 STD 3 1/2"



### General Specifications

	Standard		Quarry	
	English	Metric	English	Metric
Standard drill pipe connection (see options)	3 1/2 API reg pin		3 1/2 API reg pin	
Outside diameter (in & mm)	5.4	138	5.75	146
Length w/o bit shoulder to shoulder (in & mm)	44.6	1132	44.6	1132
Length with bit extended (in & mm)	49.5	1256	49.5	1256
Length with bit retracted (in & mm)	48.1	1221	48.1	1221
Weight w/o bit (lb & kg)	200	91	244	111
Backhead across flats (in)	2 x 4 AF		2 x 4 AF	
Minimum bit size (in & mm)	6.0	152	6.5	165
Maximum bit size (in & mm)	8.5	216	8.5	216
Bore (in & mm)	4.5	114	4.5	114
Piston weight (lb & kg)	43	19	43	19
Stroke (in & mm)	3.75	95	3.75	95
Maximum pressure differential (psig & bar)	350	25	350	25
Maximum choke diameter (in & mm)	0.38	9.6	0.38	9.6
Make-up torque (ft-lb & N-m)	6000	8124	6000	8124
Shank style	QL60		QL60	

### Air Consumption:

	QL60/65	
	QL60	QL65
100 psi/ 6,9 bar (scfm & l/s)	305	144
blows per minute	1,270	
150 psi/ 10,3 bar (scfm & l/s)	431	203
blows per minute	1,370	
200 psi/ 13,8 bar (scfm & l/s)	561	265
blows per minute	1,470	
250 psi/ 17,2 bar (scfm & l/s)	695	328
blows per minute	1,570	
300 psi/ 20,7 bar (scfm & l/s)	832	392
blows per minute	1,670	
350 psi/ 24,1 bar (scfm & l/s)	973	459
blows per minute	1,770	
400 psi/ 27,6 bar (scfm & l/s)	1,117	527
blows per minute	1,870	
435 psi/ 30,0 bar (scfm & l/s)	1,220	575
blows per minute	1,940	